



# Marvin Elementary School

5720 Brunswick Ave.

San Diego, CA 92119



Sub-district: B

Cluster: Henry

Year School Opened: 1958

Grades: K-5

① Joint Use Field

② Re-Roofing

Marvin Elementary serves the residential community of Allied Gardens. Most of the 440 (approximate) student population are from the surrounding neighborhood. The staff and community are dedicated to enriching the students with instruction and other programs. They have active parent involvement through their Parent Teacher Foundation.

The campus consists of 13 building facilities, staff parking and student drop off, hardscape playground and Decomposed Granite (DG) play field. The buildings total 42,347 square feet and include administration offices, classrooms, library and a multipurpose room. The campus was originally built in 1958 with 6 buildings and then added a library building in 2003. Over the years, portable classroom buildings were added to accommodate student population growth.



# Marvin ES Joint Use Field



Completed: February 2020

Funding: Proposition Z

This Joint Use Agreement (JUA) project with the City of San Diego involves the construction of a Full Amenities Park by the City on the schools existing Decomposed Granite (DG) Field. The agreement allows the park be used by the students during school hours and open as a public park to the community after school, on weekends and during school breaks. Project includes:

- Natural Turf
- Running Track
- Landscaping & Irrigation
- Parking Accessibility Improvements
- Drinking Fountain
- Security Fencing



Site Plan for the new Joint Use Field



# Marvin ES Joint Use Field



Marvin 10/27/2019 8 AM





# Marvin ES Re-Roofing Project



Completed: October 2021

Funding: Proposition Z

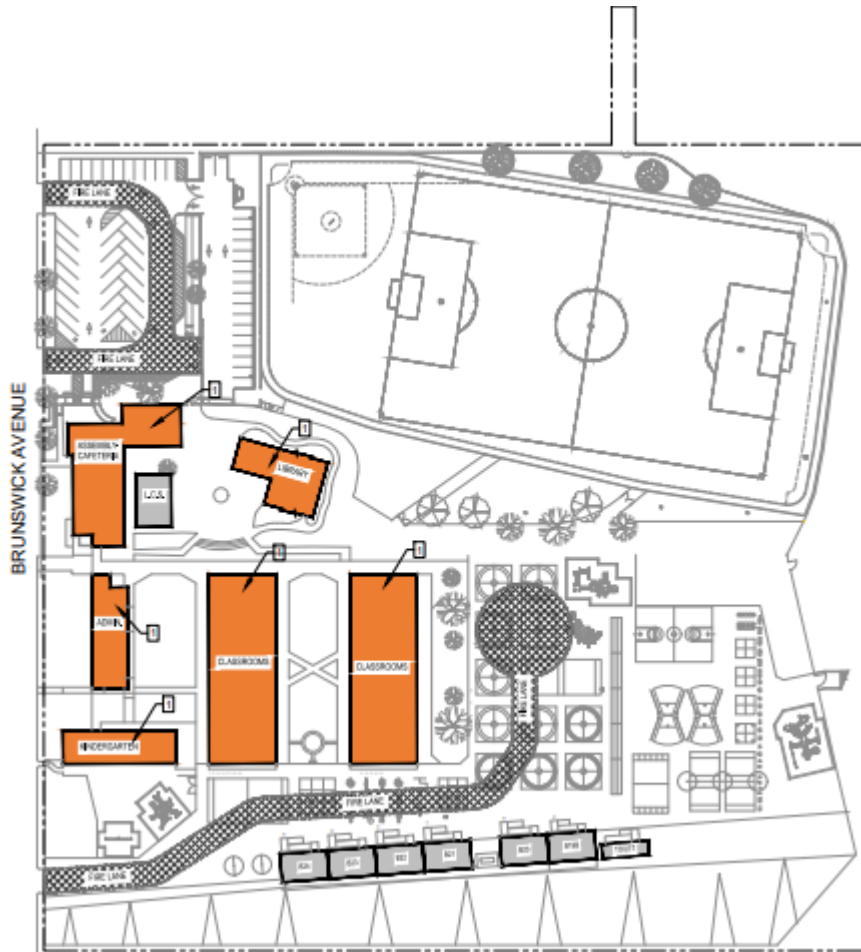

The project involves the replacement of roofs and covered walkways on buildings 01-01, 01-02, 01-03, 01-04, 01-05 and 02-06.