



Longfellow K-8 School

5055 July St.

San Diego, CA 92110



Sub-district: A

Cluster: Clairemont

Year School Opened: 1955

Grades: K-8

- ① Whole Site Modernization
- ② Joint Use Field

Longfellow K-8 School is a Spanish emersion magnet school in the Bay Park neighborhood of the Clairemont community. Students come from all over the city to attend this unique school. The student enrollment is about 830. All students become proficient in Spanish and English.

The 5.3-acre school opened in 1955 as a K-6 elementary school. Then in 1977 the school started the magnet program that continues today. The original campus was built with six permanent buildings for classrooms, administration offices, kitchen and multi-purpose room. In 1957, due to growth in the area, another classroom building was built. Over the years the school has added 17 portable classroom buildings, and in 2003 a Library building and lunch court was built. Total facility space is 50,872 square feet.



Longfellow K-8 School Whole Site Modernization



Rendering of New Campus Entry



Longfellow K-8 School Whole Site Modernization



New Campus Entry



Longfellow K-8 School Whole Site Modernization

Completed: March 2020
Funding: Propositions S and Z

The whole site modernization project at Longfellow K-8 School will feature a new classroom building and expanded multipurpose building.

The approximately 12,700-square-foot, two-story classroom building will have nine classrooms for grades 6-8. The existing

multipurpose building will be expanded to include an approximately 1,600-square-foot music classroom with a moveable partition to provide flexibility. The entrance to the administration building will be upgraded to provide more visibility and safety for the school. The school will be repainted with vibrant colors.



Rendering of new classroom building

Longfellow K-8 School Whole Site Modernization

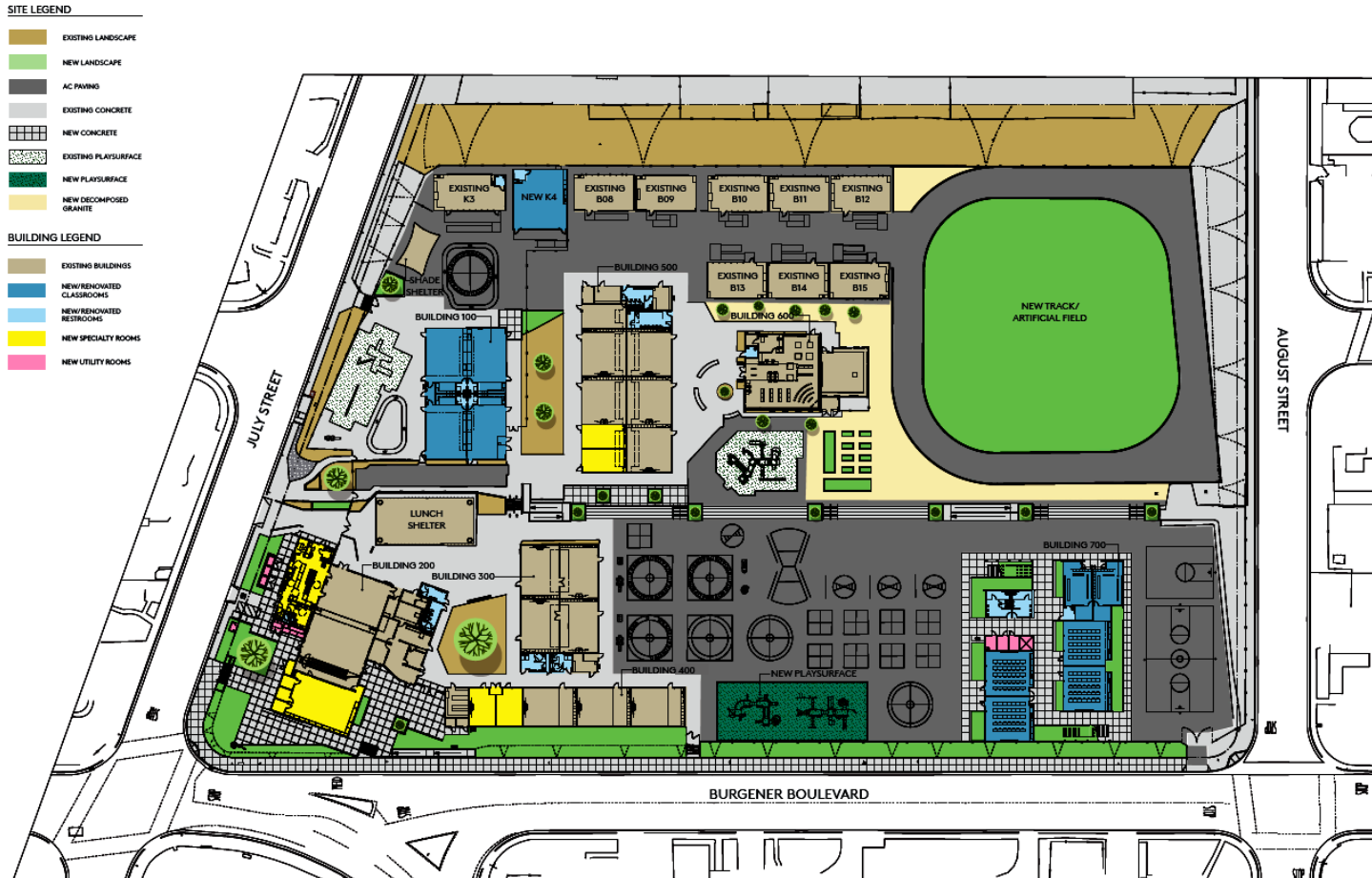

Additionally, the project will include a new kindergarten classroom, a modernized kitchen and food services area, renovated classrooms, and a re-surfaced asphalt play area. The nearly 1.5-acre synthetic turf playfield, to be installed as a separate phase, will include a perimeter asphalt walking track.

Further upgrades will include the following:

- Renovated restrooms
- Landscaping
- Installation of site-wide air conditioning
- Installation of new ornamental fencing in front of the campus
- Removal of eight portable classrooms after construction of new building

Longfellow K-8 School Whole Site Modernization



New Classroom Building



New Classroom Building



Central Stage Seating



Longfellow K-8 School Joint Use Field

Completed: September 2020
 Funding: Propositions S and Z

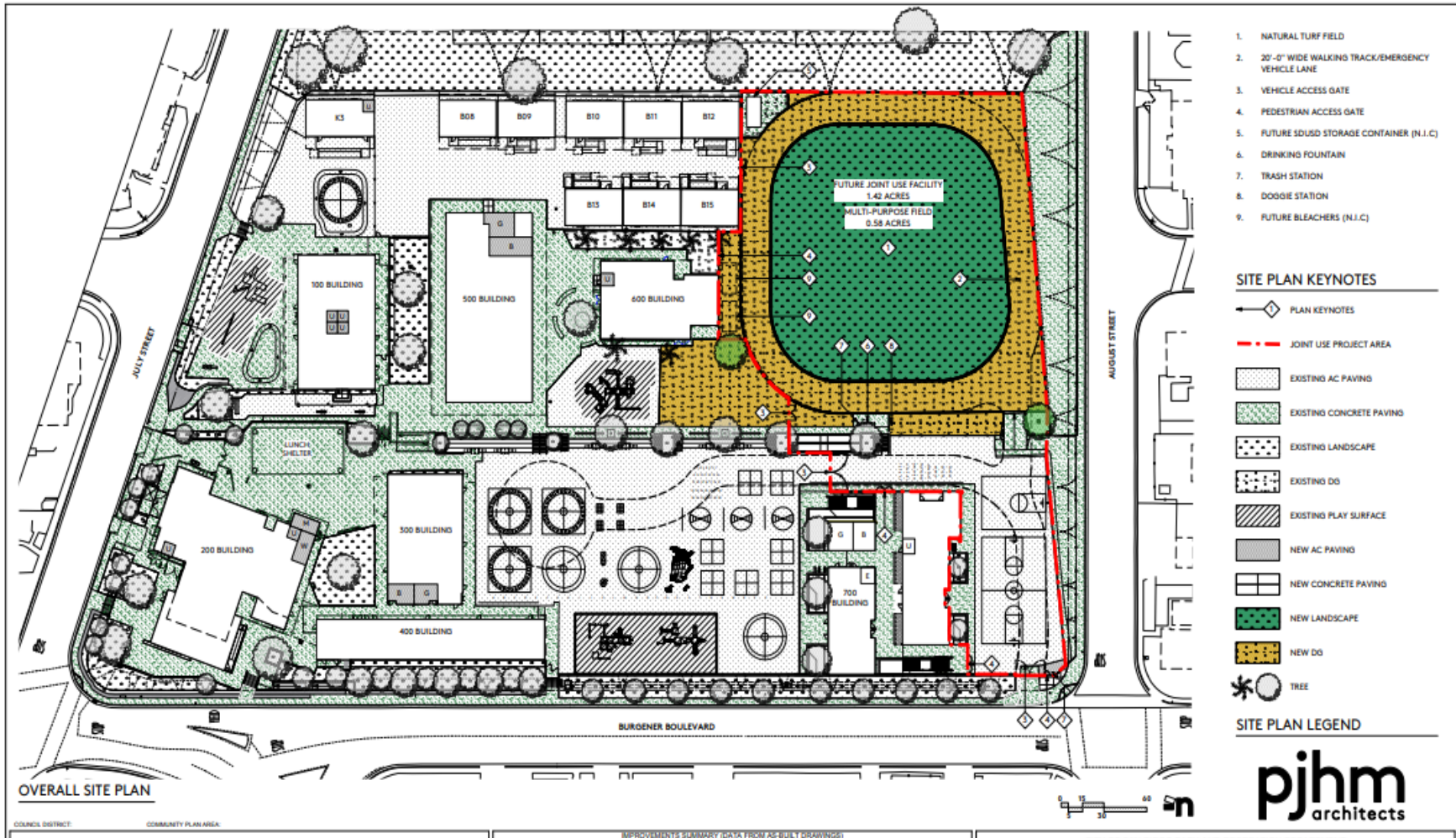

Joint Use Field Site Plan

Longfellow K-8 School Joint Use Field



Joint Use Field

Longfellow K-8 School Joint Use Field

