



# Jonas Salk Elementary School

7825 Flanders Dr.  
San Diego, CA 92126



Sub-district: A  
Cluster: Mira Mesa  
Year School Opened: 2015  
Grades: K-6



- ① New Campus Construction
- ② Joint Use Field

Jonas Salk Elementary is a new school in the southwest area of the residential Mira Mesa community. The first year of enrollment was approximately 500 students. The students represent the diverse neighborhood. The school emphasis is on STEM (Science, Technology, Engineering and Mathematics).

The campus consists of four permanent classroom buildings, a media center, administration office, covered lunch court, play structures and an indoor/outdoor multipurpose room for a total of 38,407 square feet of learning space. The school has a lunar quad that features the phases of the moon.





# Jonas Salk ES New Campus







## Salk ES New Campus

Completed: September 2015

Funding: Proposition S

Jonas Salk Elementary School is a new school located at the intersection of Flanders Dr. and Parkdale Ave. in the southwest portion of Mira Mesa. The school is designed to serve approximately 700 K-6 students and opened for the 2015-2016 school year.

The campus features include:

- Two-story classroom buildings
- Multi-purpose building
- Special Education building
- Reading specialist/learning center
- Administration building
- Lunch court shelter
- Joint-use hard-court area
- Joint-use grass playfield (to be constructed and maintained by the City of San Diego)
- On-site drop-off/pick-up areas
- On-site parking
- Solar carports



Entry gates with custom metal lettering



Front of school



# Salk ES New Campus

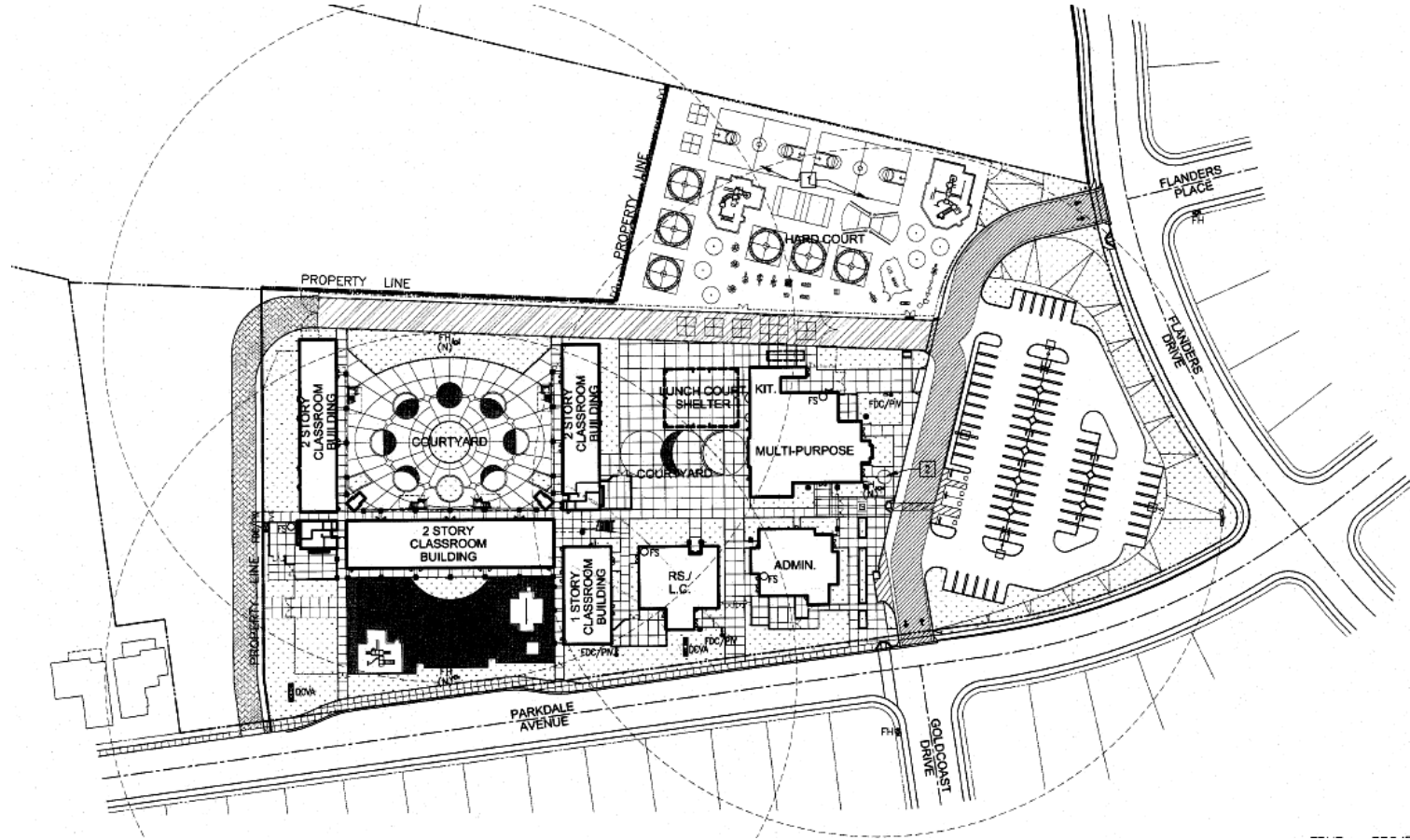

Site plan



# Salk ES New Campus



Courtyard



Solar carports



Concrete sign at intersection of Flanders Dr. and Parkdale Ave.



## Salk ES New Campus



Outdoor stage area connected to multi-purpose facility

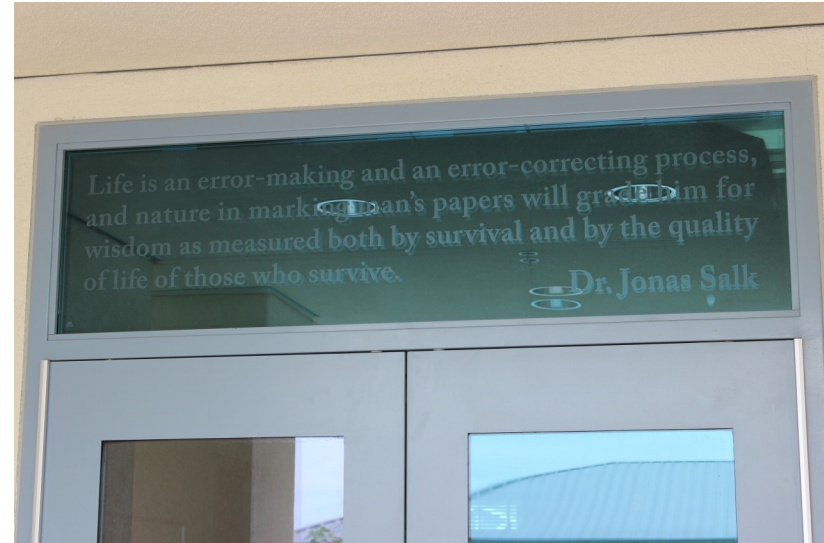

Dr. Jonas Salk quote above reading/learning center entrance



Courtyard with decorative lunar cycle and elevator tower



Kindergarten play area



# Salk ES Joint Use Field

Estimated Construction Completion: Spring 2023

The City of San Diego has designed and will construct this Joint Use Field. The project includes a clubhouse with restrooms and sail type shade structures. There will be a large walking path on school property and walking path in a connected public park not on district property. A new parking lot will be constructed just south of the school for use by the JUF.

