



Sessions Elementary School

2150 Beryl St.
San Diego, CA 92109



Sub-district: C
Cluster: Mission Bay
Year School Opened: 1956
Grades: K-5



- ① Improved Drop-off/Pick-up Zone and Parking Upgrades
- ② Fencing and Entryway

Sessions Elementary School is a small neighborhood school situated on almost 10 acres and is surrounded by residential housing. Located near Kate O. Sessions Memorial Park, Sessions is an authorized International Baccalaureate (IB) World School serving nearly 500 students in northern Pacific Beach.

The school opened in 1956, and it is comprised of five permanent buildings of wood frame. Five portable classrooms have been added at different times to accommodate increased student population. A library was added in 2003 as part of Proposition MM modernizations. The total building area is approximately 41,000 square feet. The campus features several play structures and a full-size baseball field. Sessions is located in a class 1 climate zone (coastal) as designated by San Diego Unified.



Sessions ES Pick-up/Drop-off Zone & Parking Upgrades



Completed drop-off and pick-up zone

Completed: March 2012

Funding: Proposition S

A student pick-up and drop-off zone was constructed to improve traffic and parking and to ensure safer student arrival and departure.

The new student pick-up and drop-off zone features:

- Widened driveway to the pick-up/drop-off zone and parking area
- Left-turn lanes in the east and westbound lanes of Beryl Street where it intersects with the school driveway and Noyes Street
- Adjusted traffic signal at the intersection of Beryl and Noyes streets
- Shortened pedestrian crosswalk lengths
- Relocated staff parking
- Landscaping and new 8-foot wood fence



Sessions ES Pick-up/Drop-off Zone & Parking Upgrades

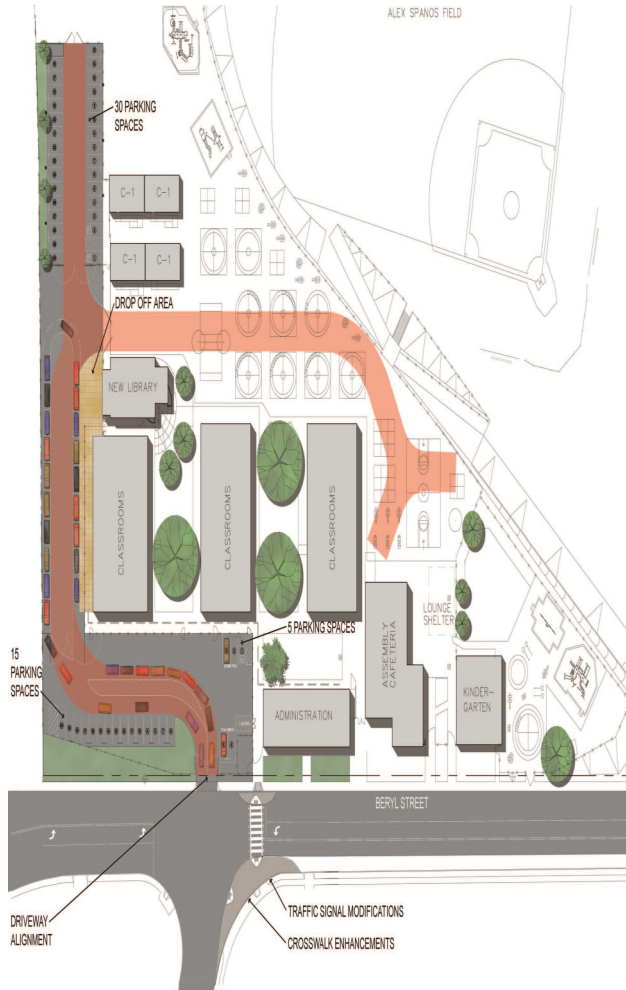

Student drop-off and pick-up zone plan rendering



Entrance and parking



Beryl street driveway intersection



Turnaround area and staff parking



Sessions ES

Fencing and Entryway



Completed: April 2021

Funding: Proposition YY

The Sessions Elementary School fencing project consisted of the installation of chain link fencing along the rear of the property near the new garden, a 6' pedestrian ornamental gate, two 6' pedestrian chain link gates, and a 10' vehicular chain link gate. A 1/2 lite front door was installed at the administration building with an intercom, electric strikes and interior and exterior card readers. The intercom has individual front door control screens at three workstations in the reception area. There is an exterior mounted security camera at the front door location and an interior security camera at front door entry reception area. Additionally, there is a 42" security monitor at the reception area.



New Fencing



Entryway